



Caledonian

Industrial Cables (German Standard)

www.caledonian-cables.com

marketing@caledonian-cables.com

H07V-U

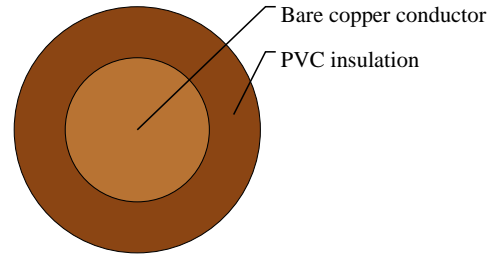
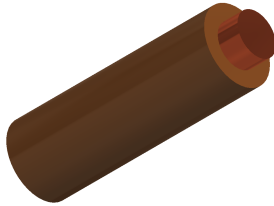

APPLICATIONS

These insulated wires are suitable for laying tubes, under and surface mounting of plasters and also in closed installation conduits. These are not allowed to install for direct laying in cable trays, channels or tanks. These types are permitted for the inner wiring of equipment, distributor and switchboards and also for protective laying to the lightings with a nominal voltage up to 1000 V alternating current or up to 750 V direct current against ground.

STANDARDS

HD 21.3 S3

VDE-0281 Part-3

VOLTAGE RATING

450/750V

CABLE CONSTRUCTION

- Solid bare copper single wire
- Solid to DIN VDE 0295 cl-1 and IEC 60228 cl-1
- Special PVC T11 core insulation

COLOUR CODE

Insulation Colour Code

Colour coded to VDE-0293

Single core - Black, Blue, Green/Yellow, Red, Yellow, White, Violet, Brown, Grey, Orange, Pink

PHYSICAL AND THERMAL PROPERTIES

- Test voltage: 2500V
- Flexing bending radius: $15 \times \varnothing$
- Static bending radius: $15 \times \varnothing$
- Flexing temperature: -5°C to $+70^{\circ} \text{C}$
- Static temperature: -30°C to $+90^{\circ} \text{C}$
- Short circuit temperature: $+160^{\circ} \text{C}$
- Flame retardant: IEC 60332.1
- Insulation resistance: $10 \text{ M}\Omega \times \text{km}$



Caledonian

Industrial Cables (German Standard)

www.caledonian-cables.com

marketing@caledonian-cables.com

DIMENSION AND PARAMETERS

No. of Cores × Cross- sectional Area	AWG Size	Nominal Insulation Thickness	Approx. Overall Diameter	Nominal Copper Weight	Approx. Weight
No. × mm ²		mm	mm	kg/km	kg/km
1 x 4	12	0.8	3.9	38.0	49